



BARRICADE[®]
BUILDING PRODUCTS

THE BEAR'S GOT YOU COVERED

**BARRICADE
THERMO-BRACE**
Structural Insulative Sheathing
Water Resistant Barrier
Mold Resistant

Barricade Building Products
Doraville, GA
www.barricadebp.com
Evaluation Report
TIR No. 1907-08

**BARRICADE
THERMO-BRACE**
Structural Insulative Sheathing
Water Resistant Barrier
Mold Resistant

**BARRICADE
THERMO-BRACE**
Structural Insulative Sheathing
Water Resistant Barrier
Mold Resistant

Barricade Building Products
Doraville, GA
www.barricadebp.com
Evaluation Report
TIR No. 1907-08

**BARRICADE
THERMO-BRACE**
Structural Insulative Sheathing
Water Resistant Barrier
Mold Resistant

Barricade Building Products
Doraville, GA
www.barricadebp.com
Evaluation Report
TIR No. 1907-08

**BARRICADE
THERMO-BRACE**

**BARRICADE
THERMO-BRACE**

**BARRICADE
THERMO-BRACE**

TRUE STRENGTH

Make Your Investment Last a Lifetime

Barricade® Thermo-Brace® is strong. Thermo-Brace's unique manufacturing process uses high-quality fiber designed to add superior dimensional stability and strength. All of our grades provide racking resistance and may be used as an alternative corner bracing method with structural ratings equivalent or better than OSB.

THERMO-BRACE®
IS STRONG

Lightweight & Easy to Handle

Thermo-Brace can be handled easily by one worker. At less than half the weight of $\frac{3}{8}$ " OSB, its combined strength and light weight allow entire walls to be constructed and lifted into place.

A knife, router, or saw can be used to cut or trim Thermo-Brace. It is also safe for workers to kneel or walk on it without causing damage.

Moisture Management

As part of the Barricade System, Thermo-Brace exterior wall sheathing is a vital component as it protects the wall envelope and preserves the integrity of what's inside, i.e. cavity insulation, studs, drywall, etc.

Fiberboard sheathings tend to be spongy because of their composition. This makes it difficult to fasten the edges tightly to the wall frame, creating gaps and cracks for water to enter.

Because of Thermo-Brace's $\frac{1}{8}$ " thickness, a tight seal is formed to the framing members, producing excellent protection against water and air infiltration.

Water and Weather-Resistant Plies

Thermo-Brace's core is composed of high quality, long fibered, specially-treated water and weather-resistant plies. These plies are pressure laminated with a special water-resistant adhesive.

All grades of Thermo-Brace have been evaluated and permitted as a water-resistive barrier (WRB) noted in IRC section R703.2 and IBC Section 1404.2.

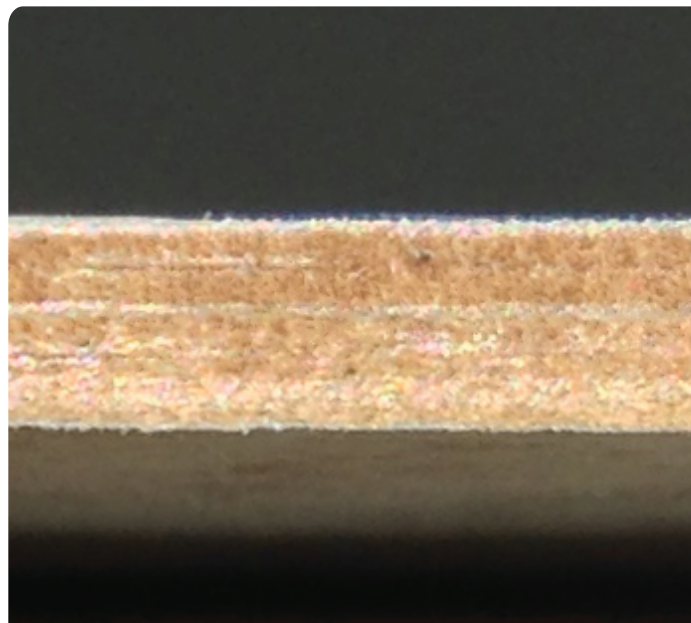

TRUE ADVANTAGE

TRUE COMPETITIVE EDGE

- Less worksite damage means lower replacement costs
- Available custom dimensions mean less waste and less site cleanup, saving time and money
- Available up to 12' lengths
- Easy installation saves time and labor
- Can be used as a draft stop*
- All grades are alternatives for exterior and interior shear load design. (See shear value tables for calculation values in evaluation reports)
- Reflective foil facings are available for enhanced energy performance
- Private logo available
- Large imprint area
- Quick turnaround
- Minimal up-charge
- Small minimum order requirement



Thermo-Brace is available in 3 grades

GREEN

Standard grade, .075" thickness.

RED

Structural grade for 16" o.c. stud spacing, .101" thickness

BLUE

Structural grade for 16" o.c. stud spacing, .126" thickness

Uses and Properties

	Green Thermo-Brace	Red Thermo-Brace	Blue Thermo-Brace
Structural Sheathing*	Yes	Yes	Yes
Corner Bracing*	No	Yes	Yes
Air Barrier*	Yes	Yes	Yes
Thermal Properties*	Yes	Yes	Yes

*Individual jurisdictions and municipalities may vary. Check with your local building officials for approval and acceptance.

SPECIFICATIONS

Composition	High-quality, long fibered, specially treated water and weather-resistant plies. Plies are pressure laminated. A special water-resistant adhesive is used.		
Standard Sizes	48" x 96" and 48¾" x 96" — 48" x 108" and 48¾" x 108"		
Custom Sizes	Custom-cut sizes up to 60" wide and 144" long are available upon request.		
	Standard Grade (Green)	Structural Grade (Red)	Structural Grade (Blue)
Thickness	0.075 ± 0.004	0.101 ± 0.005	0.126 ± 0.006
Weight	278 ± 15 lbs/MSF	368 ± 20 lbs/MSF	458 ± 25 lbs/MSF
Sheets/Skid	400	315	250
Corner Bracing Requirement	Structural up to 16" o.c.	Structural up to 16" o.c.	Structural up to 24" o.c.

Seams & Joints

For optimum energy performance, Barricade® Building Products recommends that all seams and joints be taped with a high-quality construction tape such as Barricade® Seam Tape®.

Window Treatment

If windows and doors are made to accommodate traditional ½" sheathing materials, use ¾" plywood shims around the openings for a tight, neat installation, or order windows with adjustable nailing fins from your supplier for easy adaptability to ⅝" Thermo-Brace sheathing. Thermo-Brace must be installed with appropriate flashing and counter-flashing in conformance with accepted building standards and in compliance with local building codes.

Thermo-Brace Architectural Specifications

Sheets 48" x 96" are to be applied with a small gap between panels (⅛" - 1⁄8"). Sheets 48¾" x 96" are to be overlapped ¾". Staple or nail through Thermo-Brace and into studs using 1¼" galvanized roofing nails or 16-gauge, 1" minimum crown staples with 1¼" staple leg length. Fasteners are to be spaced in accordance with manufacturers instructions. Fastening schedule is printed on each sheet of Thermo-Brace.

Where band-joint lumber shrinkage is anticipated, fasten Thermo-Brace only to the top plate of the band-joint area. Contact Barricade® Building Products for applications involving floor truss-joint systems.

INSTALLATION INSTRUCTIONS

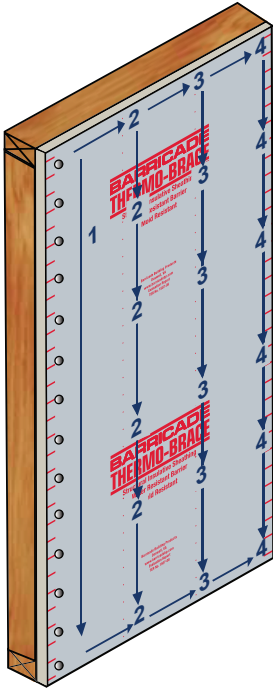

STEP 1

DO NOT fasten the four corners first.

1. Starting at the top left of the panel, begin fastening from top to bottom, referring to the fastener schedule on the front side of the panel for proper fastener spacing.

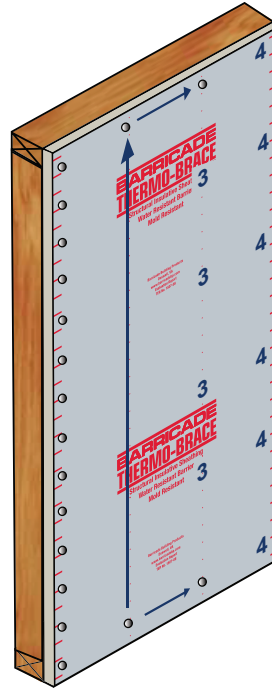

STEPS 2 & 3

2. Moving across the panel, attach fasteners at the top and bottom of the panel until you reach the next stud (it is important when using staples to fasten them in a parallel direction to the stud).

3. Fasten panel in numerical order repeating the procedure described in steps 1 and 2.

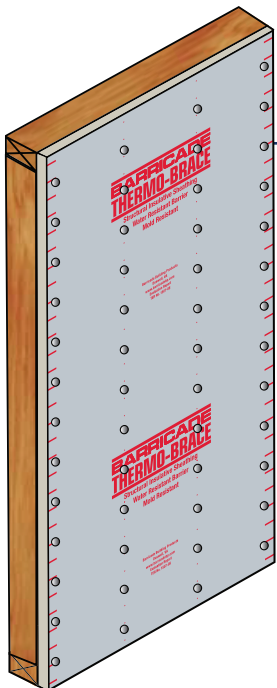

STEP 4

4. Continue until the Thermo-Brace panel is properly secured to the frame.

For use as a water-resistive barrier (WRB) noted in IRC section R703.2 and IBC Section 1404.2, use Barricade® Seam Tape® on joints and seams.



STEP 5

5. In order to prevent gaps or rippling, it is important to move cross from one side of the panel to the other when installing.

DO NOT fasten each of the four corners first.



BARRICADE®
BUILDING PRODUCTS

THE BEAR'S GOT YOU COVERED

10351 Verdon Road • Doswell, VA 23047
1-877-832-0333 • www.barricadebp.com



THE BEAR'S GOT YOU COVERED

10351 Verdon Road • Doswell, VA 23047
1-877-832-0333 • www.barricadebp.com